

THIS KIT CONTAINS: 1 Line Side 'Y' Insert assembly
1 Load Side housing
1 Line Side housing
1 Socket contact
1 Packet of lubricant
1 Assembly Dowel

⚠ WARNING: Improper use or installation of this product may cause fire, electrocution, serious personal injury or death. Shut off power to the circuit or remove fuse before using this product. Use only connector properly sized to the wiring being used. Consult local building codes for installation requirements.

INSTALLATION INSTRUCTIONS

CAUTION: Identify **LINE** and **LOAD** sides of wiring with correct molded connector bodies before installing.

**MAX. 75°C (167°F) OPERATING TEMPERATURE 600 VOLT 1/10-30 AMP
Cu or Al Conductors**

LINE SIDE

1. Measure or determine the outside diameter of the wire on the Line Side, and from CHART A, select the correct size for the molded sleeve and cut off to the size required.
2. **Thoroughly clean** approximately 6" of the insulation at the end of the Line Side wires and apply a light coating of lubricant (do not substitute) to the cleaned insulation and the small holes in the Line Side housing. Push the line side wires into the Line Side housing as shown in Step 1.
3. Strip the Line Side wires approximately 5/8". An application of oxidation inhibitor such as Noalox® is required on properly cleaned aluminum conductors. Tighten set screws on both conductors, as illustrated in Step 2, with a 5/32" hex key.
4. Tighten center set screw on insert contact if it is not already tight, this assembly should look like Step 3. Plug "Y" insert into Line Side housing.

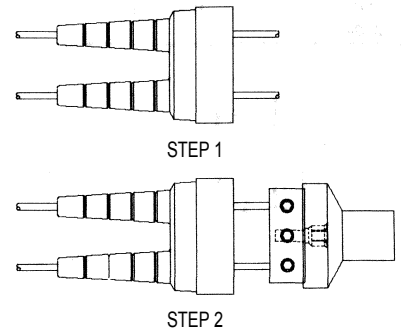

LOAD SIDE

1. Measure or determine the outside diameter of the wire on the Load Side, and from CHART B, select the correct size for the molded sleeve and cut off to the size required. Example: If cable O.D. is 0.27", it falls within the "C" range-cut off between "B" and "C".
2. **Thoroughly clean** approximately 8" of the Load Side wire insulation and apply a light coating of lubricant to the cleaned wire insulation and the small hole in the Load Side housing.
3. Insert the wire through the small hole in the housing, and push through sufficiently to allow for stripping insulation.
4. For wire sizes 14 AWG through 10 AWG strip wire 3/4". For wire sizes 8 AWG through 2 AWG strip 3/8" (DO NOT PENCIL INSULATION). An application of oxidation inhibitor such as Noalox® is required to properly cleaned aluminum conduction, crimp on the Load Side socket contact. (Refer to chart C for correct tool & die).
5. For ease of assembly, first apply a small amount of lubricant to the opening in the housing for the socket contact. Place assembly dowel in socket. Place free end of dowel against firm surface and push housing forward until the socket snaps into a locked position. Wipe off lubricant.
6. Insert appropriately rated 1-1/2" x 13/32" fuse, 600 volt - 30 Amp Max. (Do not use glass tube or indicating fuse type), in the Load Side Housing, **CAUTION: WHEN THE FUSE IS FULLY SEATED, THE END OF THE FUSE WILL PROTRUDE NO MORE THAN 5/8" PAST THE END OF THE HOUSING. DO NOT APPLY LUBRICANT ON THE FUSE.**
7. Plug Load Side housing into Line Side assembly. If less breakaway force is desired, lubricate mating surfaces with grease supplied. **CAUTION: WHEN PROPERLY MATED, THE SEAM BETWEEN THE HOUSINGS SHOULD NOT EXCEED 1/32".**

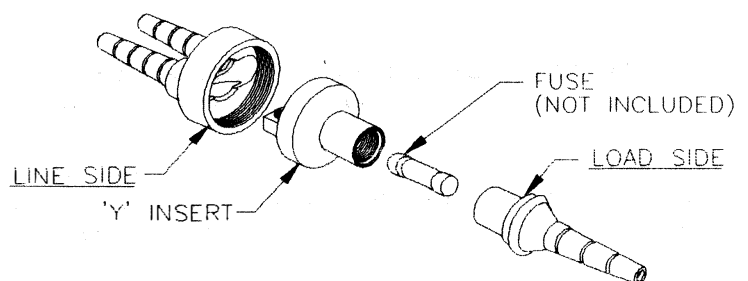
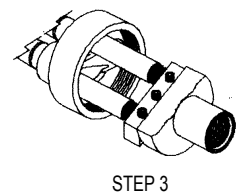

WARRANTY: One-year limited warranty. See www.idealind.com or call Customer Assistance for warranty details.

⚠ WARNING: Cancer - www.P65Warnings.ca.gov.

IDEAL INDUSTRIES, INC.
Sycamore, Illinois 60178, U.S.A.
800-435-0705 Customer Assistance
idealind.com
Made in USA of US & Global components.
AW1661D 1838540



Noalox® is a registered trademark of IDEAL INDUSTRIES, INC.

**EXCERPTS OF 1996 US NEC TABLES 5 & 5A
DIMENSIONS OF INSULATED CONDUCTORS**

Size in AWG	Approx. Diameter in Inches for Insulation						Approx. Diameter in Inches for Compact Al Conductors		
	RH	RHH, RHW, RHW-2	THW, THW-2, THHW	TW	THHN, THWN, THWN-2	XHHW, XHHW-2	THW, THHW	THHN	XHHW
14	.163	.193	.163	.133	.111	.133	—	—	—
12	.182	.212	.182	.152	.130	.152	—	—	—
10	.236	.236	.206	.176	.164	.176	—	—	—
8	.326	.326	.266	.236	.216	.236	.255	—	.224
6	.364	.364	.304	.304	.254	.274	.290	.240	.260
4	.412	.412	.352	.352	.324	.322	.335	.305	.305
3	.440	.440	.380	.380	.352	.350	—	—	—
2	.472	.472	.412	.412	.384	.382	.390	.360	.360

National Electric Code®, Copyright© 1996, National Fire Protection Association, Quincy, MA 02269

CHART A - LINE SIDE HOUSING (inches)

CABLE O.D. (inch) or CABLE O.D. (inch)			
A	.155-.205	A	.420-.505
B	.195-.260	B	.495-.585
C	.250-.330	C	.575-.685
D	.320-.380	D	.675-.785
E	.370-.430		

CHART B - LOAD SIDE HOUSING (inches)

CABLE O.D. (inch) or CABLE O.D. (inch)	
A	.120-.205
B	.195-.260
C	.250-.330
D	.320-.430

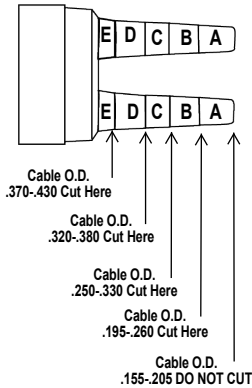

OR

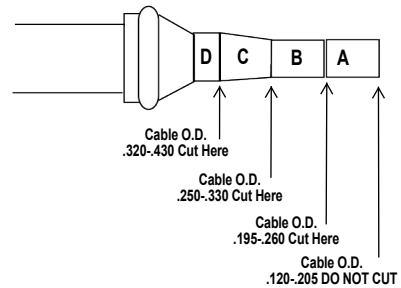
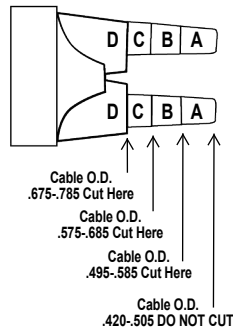

LINE SIDE

LOAD SIDE

ASSEMBLED KIT

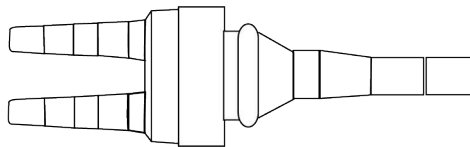

CHART C



UNIVERSAL CONTACT C OR A			
CRIMP AREA	CONDUCTOR SIZE IN AWG		RECOMMENDED CRIMP TOOLS & DIES OR DIMENSIONAL EQUIVALENT
	SOLID	STRANDED	
A	14, 12 10, 8	14, 12 10	IDEAL No. 30-429 "BARE" IDEAL No. 30-429 "BARE"
B	6 4	8 6	IDEAL No. 30-425 large crimp area IDEAL No. 30-425 large crimp area
LARGE CONTACT LC OR LA			
L	2 -	4 2	IDEAL No. 30-425 large crimp area IDEAL No. 30-425 large crimp area

NOTE: ALUMINUM PARTS HAVE A SCRIBED LINE ON BARREL DIAMETER - OXIDATION INHIBITOR REQD.